



# DBC 114067 SHD (M)

Rear view camera

Heavy duty shutter camera



WEITERE INFOS

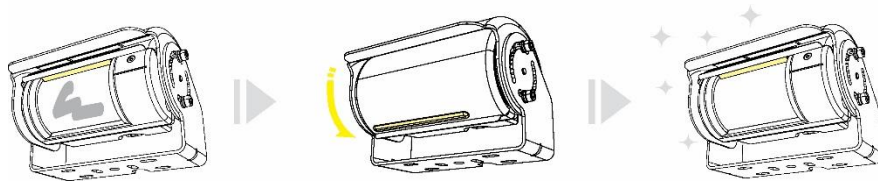

## Features:

- Motorized color-camera with shutter and wiper
- Wide viewing angle 150°
- Waterproof IP69K
- 8 IR LED beamer for high performance in dark areas (0 lux)
- Built-in microphone
- Mirror/normal switch
- Automatic radiator
- Incl. 20 m connection cable

Technische Änderungen und Irrtümer vorbehalten.



# DBC 114067 SHD (M)

## Rear view camera

### Heavy duty shutter camera



#### Technical data:

- Sony 1.23 megapixel chipset
- Resolution: 700 TVL (ca. 480.000 pixels)
- Built-in microphone
- Protection class: IP69K
- Mirror/normal switch
- Viewing angle: 146° diagonal, 116° horizontal, 93° vertical
- With wiper-function during opening and closing of the shutter
- Signal / noise ratio: >46 dB (AGC off)
- Waterproof Al. housing
- Automatic, electronic iris
- Minimum illumination: 0 lux
- Vibration resistant up to 10 G
- Shock resistant up to 100 G
- Power supply: 12 V
- Power consumption: < 200 mA
- Operating temperature range: -40 °C to +80 °C
- Storage temperature range: -30 °C to +80 °C
- Dimensions (WxHxD) 104 x 57 x 55 mm
- Weight: approx. 480 g